

Direct Drive Fans

High Pressure High Velocity

MODELS HV & HVEX



- FEATURES**
- Fully Assembled - Ready to Install
 - Totally Enclosed & Explosion Proof Motors



Fans With Totally Enclosed Motors

◀ = EDP in stock

EDP Number	Catalog No.	Prop Dia.	Motor HP	RPM	0" SP CFM	1/8" CFM	1/4" CFM	3/8" CFM	1/2" CFM	Max Sones @ 5'	Volts	PH	Ship Wt.	List Price
◀25300	H12V76-1	12"	1/6	1750	1480	1360	1220	886	734	10.7	115/230	1	28	\$1,073
◀25305	H16V76-1	16"	1/2	1750	2700	2590	2390	2100	1740	18.5	115/230	1	44	\$1,307
25310	H16V836-1	16"	1/2	1750	2700	2590	2390	2100	1740	18.5	230/460	3	39	\$1,258
25315	H18V76-1	18"	1/2	1750	3900	3780	3575	3280	2880	23.0	115/230	1	46	\$1,403
◀25320	H18V836-1	18"	1/2	1750	3900	3780	3575	3280	2880	23.0	230/460	3	42	\$1,362
◀25335	H24V76-2	24"	1	1750	6860	6560	6240	5900	5426	35.4	115/230	1	88	\$1,815
◀25340	H24V836-2	24"	1	1750	6860	6560	6240	5900	5426	35.4	230/460	3	79	\$1,624
25355	H30V76-1	30"	1	1150	9470	8750	8030	7100	5900	29.0	115/230	1	51	\$3,355
25360	H30V836-1	30"	1	1150	9470	8750	8030	7100	5900	29.0	230/460	3	118	\$2,107
◀25365	H30V836-3	30"	3	1750	14400	13900	13450	13000	12500	60.1	230/460	3	130	\$2,297
25385	H36V836-3	36"	1-1/2	1150	13300	12400	11600	10600		37.1	230/460	3	203	\$2,494
◀25390	H36V836-1	36"	3	1750	16890	16179	15504	14816	14125	80.1	230/460	3	205	\$2,510
◀25395	H36V836-2	36"	5	1750	20300	19650	19100	18600	17950	76.5	230/460	3	225	\$2,859
25415	H42V836-3	42"	1-1/2	1150	15789	15044	14059	13020	11690	51.8	230/460	3	240	\$3,266
25420	H42V836-1	42"	3	1150	22100	21300	20500	19650	18650	51.3	230/460	3	295	\$3,902
◀25425	H42V836-2	42"	5	1150	26640	25968	25250	24350	23250	62.3	230/460	3	320	\$4,113
25445	H48V836-3	48"	3	850	27420	25800	24350	22600		40.7	230/460	3	315	\$5,581
◀25450	H48V836-2	48"	7-1/2	1150	37100	35800	34700	33600	32450	70.2	230/460	3	360	\$5,985

Fans With Explosion Proof Motors

EDP Number	Catalog No.	Prop Dia.	Motor HP	RPM	0" SP CFM	1/8" CFM	1/4" CFM	3/8" CFM	1/2" CFM	Max Sones @ 5'	Volts	PH	Ship Wt.	List Price
25325	H18VEX76-1	18"	1/2	1750	3990	3780	3480	3020	2250	23.0	115/230	1	55	\$1,822
25330	H18VEX836-1	18"	1/2	1750	3990	3780	3480	3020	2250	23.0	230/460	3	49	\$2,043
25345	H24VEX76-2	24"	1	1750	7820	7690	7450	7070	6450	35.4	115/230	1	47	\$2,250
25350	H24VEX836-2	24"	1	1750	7820	7690	7450	7070	6450	35.4	230/460	3	118	\$2,350
25370	H30VEX76-1	30"	1	1150	10440	9750	8750	7640	6000	29.0	115/230	1	110	\$5,298
25375	H30VEX836-1	30"	1	1150	10440	9750	8750	7640	6000	29.0	230/460	3	118	\$4,245
25380	H30VEX836-3	30"	3	1750	16000	15350	14700	13850	12900	60.1	230/460	3	202	\$4,210
25400	H36VEX836-3	36"	1-1/2	1150	17620	16500	15200	13620	12300	37.1	230/460	3	203	\$4,428
25405	H36VEX836-1	36"	3	1750	18500	17700	15700	15100	13900	80.1	230/460	3	205	\$4,457
25410	H36VEX836-2	36"	5	1750	23000	22150	21100	20200	19000	76.5	230/460	3	225	\$5,363
25435	H42VEX836-1	42"	3	1150	24500	23150	23000	22000	19650	51.3	230/460	3	275	\$5,928
25440	H42VEX836-2	42"	5	1150	28970	27960	26840	25700	24200	62.3	230/460	3	320	\$6,659
25460	H48VEX836-2	48"	7-1/2	1150	37000	35000	32800	30600	28000	70.2	230/460	3	360	\$8,520

Air Delivery Based on Standard Test Codes of AMCA.

Explosion Proof motors are Class I, Group D and Class II, Groups F and G. UL listed. Propellers on

Explosion Proof Models have spark resistant aluminum blades. See page 55, 56 for further Explosion Proof Motor information. Shutters and Motor Kits are not Explosion Proof. Do not use speed control with HVEX fans.



Fans With Explosion Proof Motors

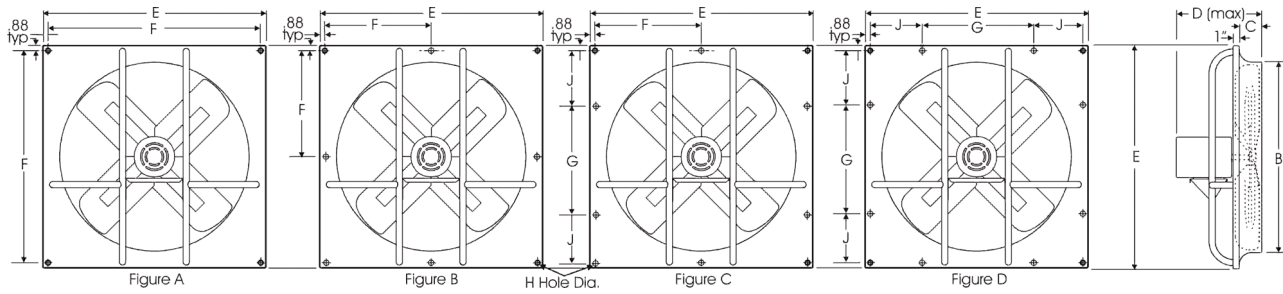

DIMENSIONS (Inches)

See Fig.	Fan Size A	B	C	D		E	F	G	J	H (Dia.)	No. Holes
				1 Phase (Max)	3 Phase (Max)						
A	12"	12.25	1.25	10		16	14.25		-	.38	4
A	16"	16.5	1.75	12	12.25	22	18.25		-	.38	4
A	18"	18.5	1.75	10	10	24	22.25		-	.38	4
B	24"	24.5	2.50	12	12.25	30	14.12		-	.62	8
B	30"	30.5	3.00	15	14.75	36	17.12		-	.62	8
C	36"	36.5	3.25	15	15.75	42	21.12	20.25	10	.62	10
D	42"	42.5	3.25		20.00	48	---	20.25	13	.62	12
D	48"	48.5	3.25		22.50	54	---	20.25	16	.62	12

NOTES:

For Supply Duty, add "S" prefix to EDP Number and use list price divided by 0.80.

Explosion Proof Motors are Class I, Group D and Class II, Groups F and G. UL Listed Propellers on Explosion Proof Models have spark resistant aluminum blades. See page 51 for further Explosion Proof Motor information.

If Supply Shutter is remote from fan, it must be motorized. Shutters and Motor Kits are not Explosion Proof.

Direct Drive Fans

HV & HVEX Accessories

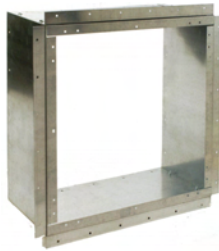

Recommended Optional Accessories For Fans With Totally Enclosed Motors & Explosion Proof Motors

WR Exhaust Shutter

EDP Number	Catalog No.	List Price
22765	WR12E	\$124
22775	WR16E	\$158
22785	WR18E	\$171
22795	WR24E	\$227
22805	WR30E	\$310
22815	WR36E	\$388
22825	WR42E	\$629
22835**	WR48E	\$734
22747†	WRHD48	\$1,051

WS Wall Collar

EDP Number	Catalog No.	List Price
06884	WS12	\$242
06886	WS18E	\$319
06894	WS18	\$299
06887	WS24	\$316
06888	WS30	\$477
06889	WS36	\$507
06890	WS42	\$586
06891	WS48	\$678

WC Supply Shutter*

EDP Number	Catalog No.	List Price
22611	WC12	\$154
22621	WC16	\$162
22631	WC18	\$193
22641	WC24	\$241
22651	WC30	\$340
22661	WC36	\$450
22671	WC42	\$633
22681	WC48	\$760

Safety Guard Prop Side (Front)

EDP Number	Catalog No.	Wt.	List Price
23660	12FG	7	\$224
23665	16FG	11	\$238
23670	18FG	11	\$271
23675	24FG	15	\$299
23680	30FG	19	\$327
23685	36FG	27	\$400
23690	42FG	34	\$474
23695	48FG	40	\$518

NOTES:
Do not use Shutter Motor Kits with Explosion Proof Motors. WS Wall Collars are shipped knocked down. WC Supply Shutters are not weather resistant. It is recommended that the WC be used with a weatherhood. 48" & 54" Shutters - Double Panel Type; 60" - 3 Panel Type; 24" - 48" Weatherhoods Available.
See page 60 for WS Collar Dimensions.
See page 55, 56 for Heavy Duty Shutters.
See page 59 for WRE and WC shutter selection/installation information, ship weights and cautions.

Safety Guard Motor Side (Rear)

EDP Number	Catalog No.	Wt.	List Price
23605	12RG	15	\$260
23610	16RG	21	\$327
23615	18RG	23	\$372
23620	24RG	28	\$393
23625	30RG	37	\$421
23630	36RG	64	\$688
23635	42RG	75	\$882
23640	48RG	85	\$1,076

NOTE: When a WRE or WC shutter is used for exhaust or supply and mounted remote from the fan, a WS Wall Collar is not needed. The shutter is installed directly on the wall and a Motor Actuator Kit must be utilized. WR42E and WR48E are two panel construction. See page 61 for prop side (front) and motor side (rear) guard dimensions. See below for Motor Kits for motorized wall louvers.

Optional Weatherhoods

EDP Number	Catalog No.	List Price
99915	WH24	\$812
99916	WH30	\$1,012
99917	WH36	\$1,252
99921	WH42	\$1,462
99923	WH48	\$1,612

See page 61 for Weatherhood Dimensions.

For Motorized Wall Shutters Add Motor Kit*

Exhaust Motor Kits

EDP Number	Catalog No.	Description	List Price
22930	MK-4620-F	120/240 Volt, for 9" - 36" exhaust shutters	\$347
22935	MK-4620-C	440 Volt, for 9" - 36" exhaust shutters	\$347
22938	MK-4620-E	550 Volt, for 9" - 36" exhaust shutters	\$365
22940	MK-4621-F	120/240 Volt, for 42" - 48" exhaust shutters	\$559
22945	MK-4621-C	440 Volt, for 42" - 48" exhaust shutters	\$559
22948	MK-4621-E	550 Volt, for 42" - 48" exhaust shutters	\$532
22930	MK-4620-F	120/240 Volt, for 54" - 60" exhaust shutters**	\$347
22935	MK-4620-C	440 Volt, for 54" - 60" exhaust shutters**	\$347
22938	MK-4620-E	550 Volt, for 54" - 60" exhaust shutters**	\$365

Please specify voltage needed when ordering.

Units are for single phase operation.

** 54" requires 2 motor kits (MK-4620) and 60" requires 3 motor kits (MK-4620).

Exhaust shutter Manual chain operators

EDP Number	Description	List Price
02684	1 Panel Shutter for 10" - 36"	\$180
02686	2 Panel Shutters for 42" - 54"	\$409
32686	3 Panel Shutters for 60"	\$546

Supply Motor Kits

EDP Number	Catalog No.	Description	List Price
22900	MK-5047-F	120/240 Volt, for 9" - 36" supply shutters	\$347
22905	MK-5047-C	440 Volt, for 9" - 36" supply shutters	\$318
22908	MK-5047-E	550 Volt, for 9" - 36" supply shutters	\$318
22910	MK-4782-F	120/240 Volt, for 42" - 48" supply shutters	\$556
22915	MK-4782-C	440 Volt, for 42" - 48" supply shutters	\$556
22918	MK-4782-E	550 Volt, for 42" - 48" supply shutters	\$534
22900	MK-5047-F	120/240 Volt, for 54" - 60" supply shutters***	\$347
22905	MK-5047-C	440 Volt, for 54" - 60" supply shutters***	\$318
22908	MK-5047-E	550 Volt, for 54" - 60" supply shutters***	\$318

Please specify voltage needed when ordering.

All units are for single phase operation.

*** 54" requires 2 Motor Kits (MK-5047) and 60" requires (1) one MK-5047 plus (1) one MK-4782 motor kits.

